



**57 North Acre, Andover, SP11 6QD**  
**£1,350 Per Month**

## PROPERTY DESCRIPTION BY *Tanya Owens*

Graham and Co are delighted to present this three bedroom family home. The property comprises an entrance porch, entrance hall, downstairs cloakroom, kitchen, dining room/study and lounge. Upstairs there are three bedrooms and a family bathroom. Externally the property benefits from driveway parking and a rear garden with a store.

Available end of July.  
Unfurnished.

### North Acre, SP11

Approximate Gross Internal Area = 88.9 sq m / 957 sq ft  
Shed = 3.3 sq m / 35 sq ft  
Total = 92.2 sq m / 992 sq ft

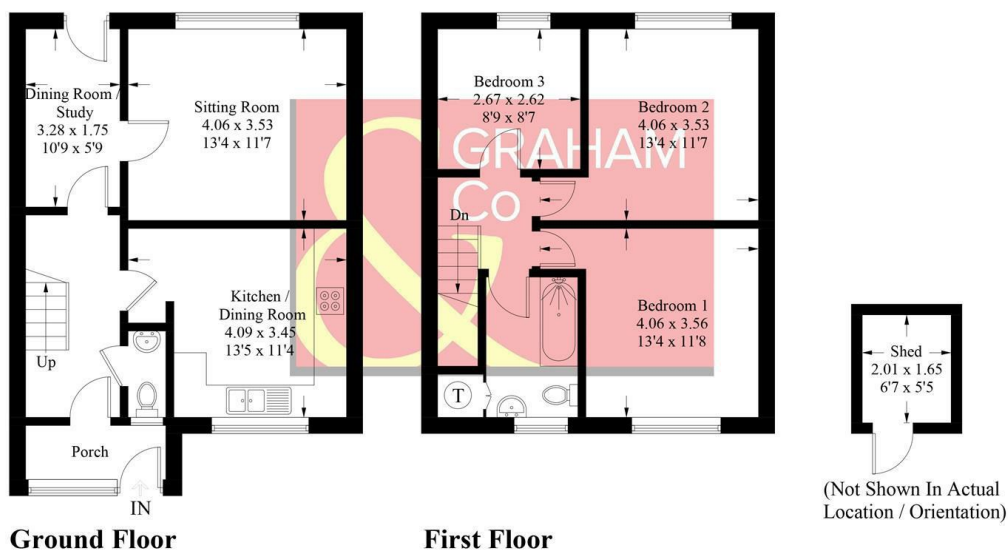

#### PRODUCED FOR GRAHAM AND CO

Whilst every attempt has been made to ensure the accuracy of the floorplan, measurements of doors, windows and rooms are approximate. These plans are for representation purposes only as defined by RICS Code of Measuring Practice and used as such by any prospective purchaser. © Emzo Marketing (ID989795)

## DIRECTIONS

Leave Andover in an easterly direction on the A303 and take the turning signposted Longparish. Proceed into the centre of the village, past the Cricketers, and turn left and then take the turning on the left into North Acre just before the village shop.

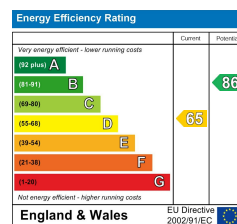

Tax Band: C



OPEN 7 DAYS

If you are considering selling your home please contact us today for your free no obligation valuation

**01264 356500**

IMPORTANT: we would like to inform prospective purchasers that these sales particulars have been prepared as a general guide only. A detailed survey has not been carried out, nor the services, appliances and fittings tested. Room sizes should not be relied upon for furnishing purposes and are approximate. If floor plans are included, they are for guidance only and illustration purposes only and may not be to scale. If there are any important matters likely to affect your decision to buy, please contact us before viewing the property.